

EINZELTEIL-LISTEN

SPARE-PARTS-LISTS

**Für das
Versenkregnerprogramm**

**For
pop-up-sprinklers**

LVZA

LVZE

LVZR

RVR

VP2M

HYDRA-XS

HYDRA-S

HYDRA-M

HYDRA-L

LVZA 22-1 / LVZA 22-2W

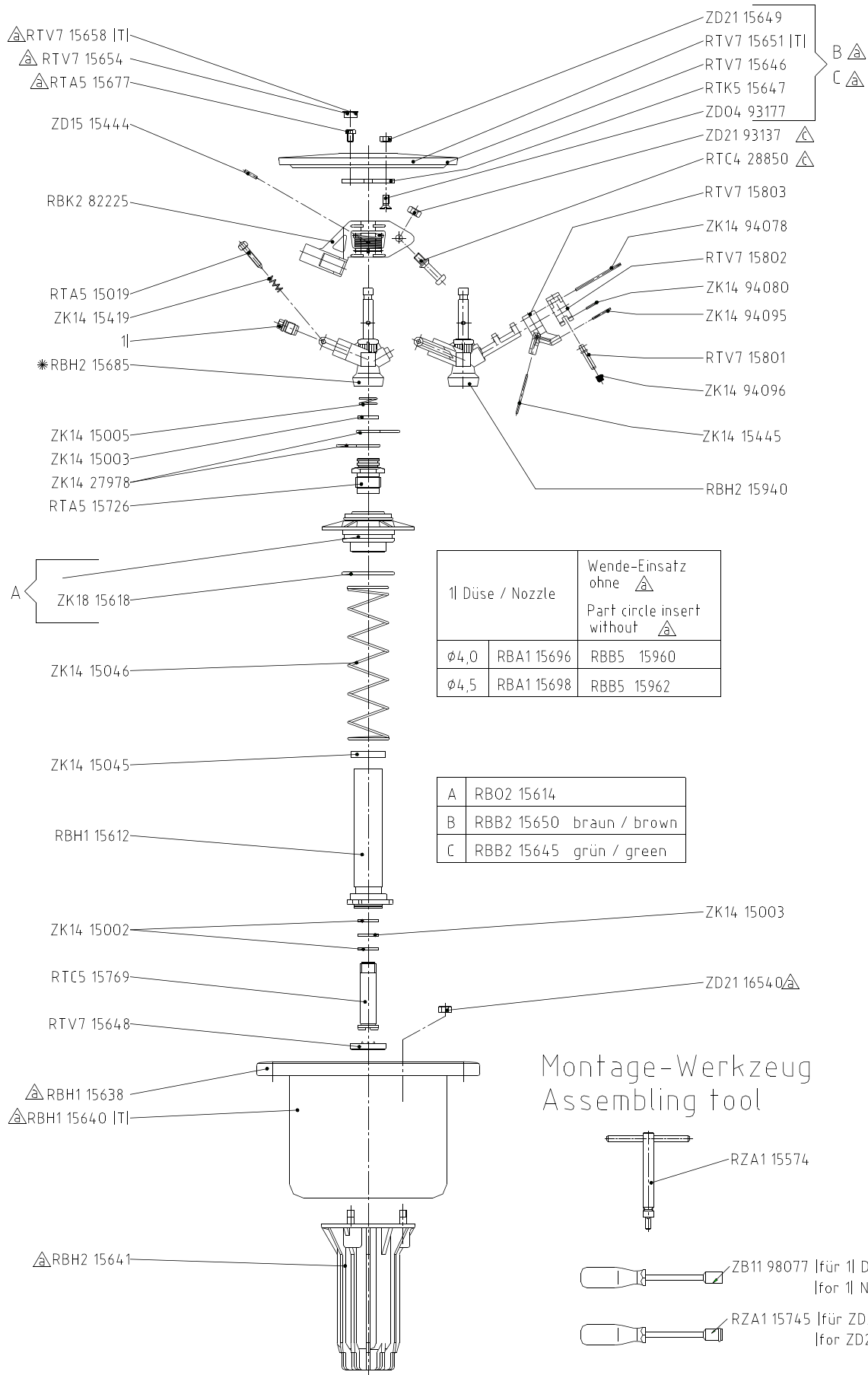

*Bei D-Krümmen Ausgleichsbohrung $\phi 2,2$ selbst anbringen
 Hole $\phi 2,2$ for secondary nozzle has to be drilled

Stand: 04.08.2010
 ERV9 00325

LVZA 22-1H / LVZA 22-2WH

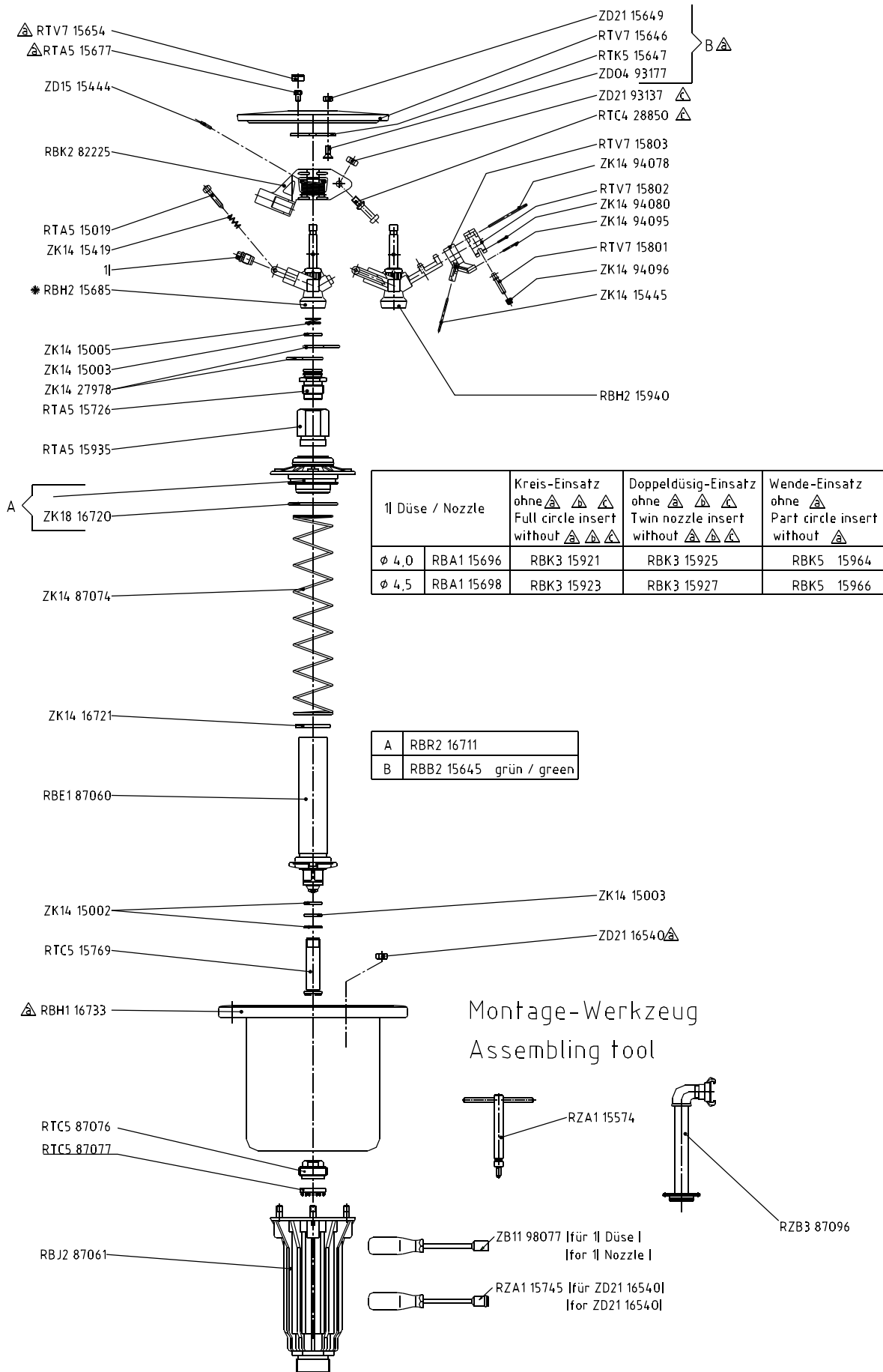

*Bei D-Krümmen Ausgleichsbohrung φ2,2 selbst anbringen
 Hole φ2,2 for secondary nozzle has to be drilled

Stand: 04.11.2010
 ERV9 00327

Umbausatz/Update Kit LVZA22 für/for LVZA30

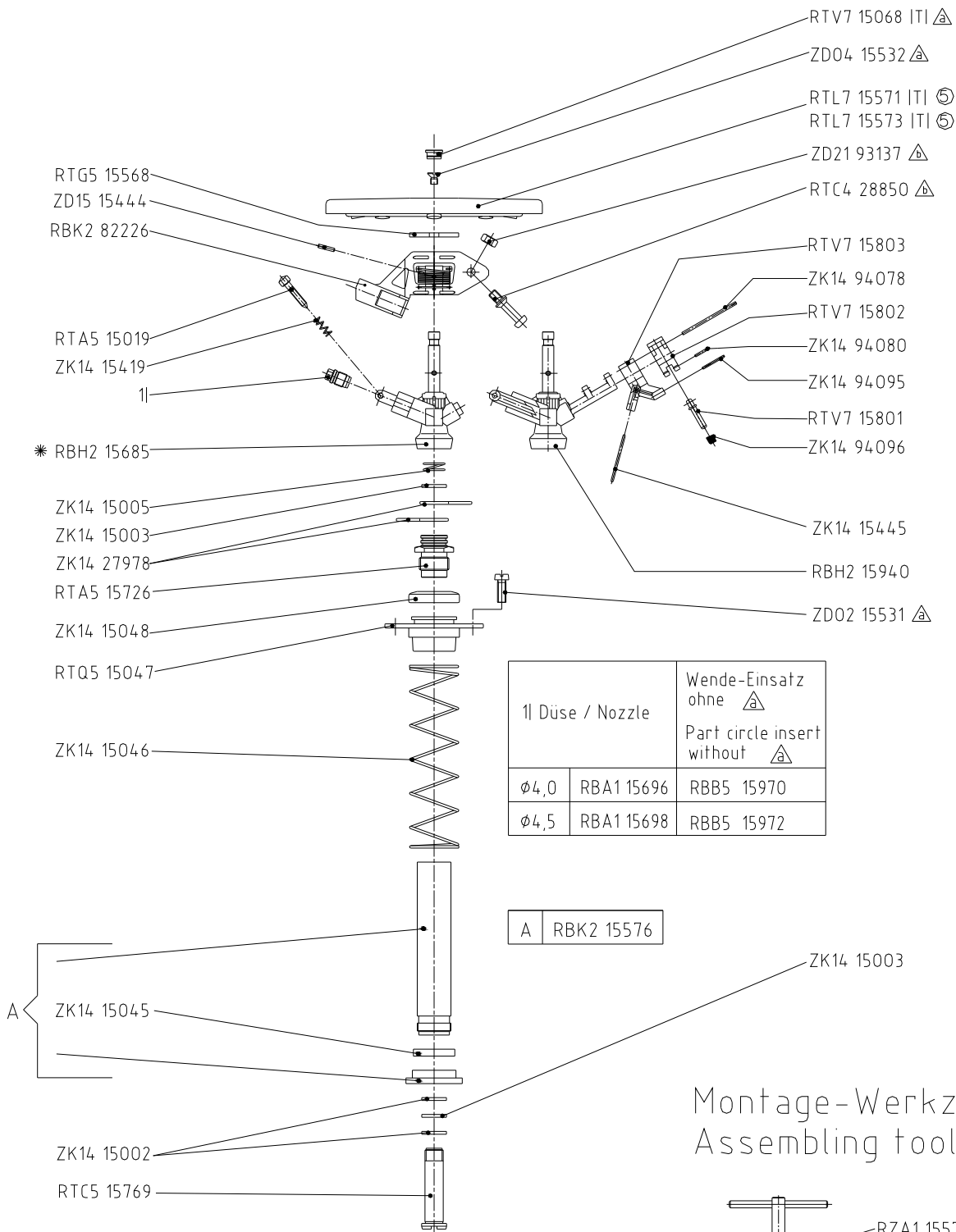

* Bei D-Krümmen Ausgleichsbohrung φ2,2 selbst anbringen
Hole φ2,2 for secondary nozzle has to be drilled

⊗ RTL7 15571 = für Gehäuse mit Schutzring
RTL7 15571 = for housing with protection ring

⊗ RTL7 15573 = für Gehäuse ohne Schutzring
RTL7 15573 = for housing without protection ring

Montage-Werkzeug
Assembling tool

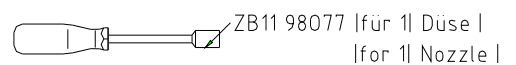
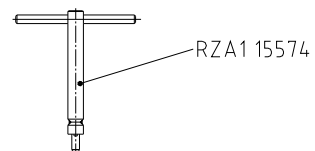

Stand: 01.11.2009
ERV9 00326

LVZE 22-1 / LVZE22-2W / WD

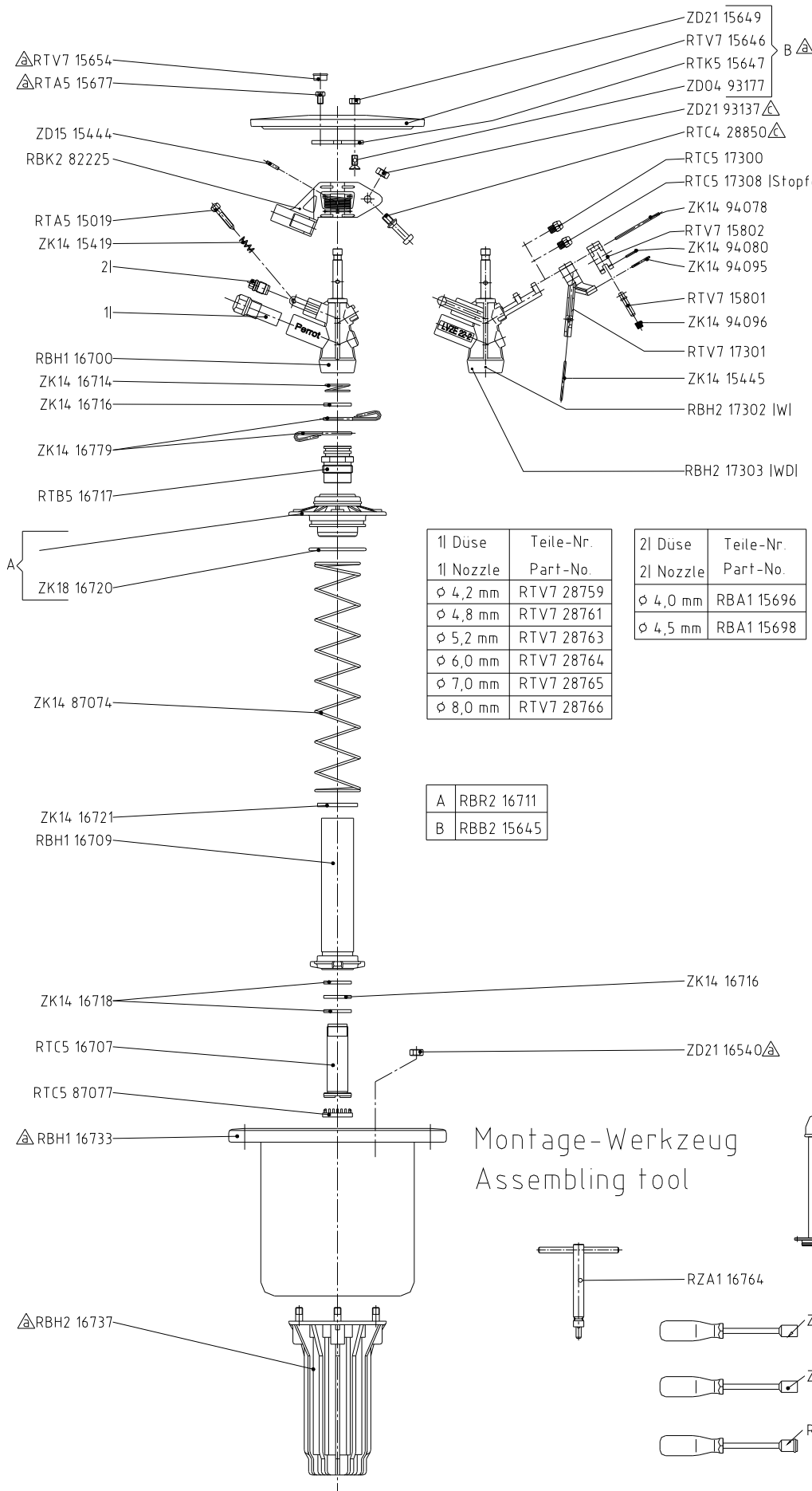

LVZE 22-1	
Düsenø	Kreis-Einsatz ohne
Nozzleø	Full circle insert without
ø 4,2x4,0x3,0	RBK5 16 668
ø 4,8x4,0x3,0	RBK5 16 669
ø 5,2x4,0x3,0	RBK5 16 670
ø 6,0x4,8x3,0	RBK5 16 671
ø 7,0x4,5x3,0	RBK5 16 672
ø 8,0x4,5x3,0	RBK5 16 673

1l Düse	Teile-Nr.	2l Düse	Teile-Nr.
1l Nozzle	Part-No.	2l Nozzle	Part-No.
ø 4,2 mm	RTV7 28759	ø 4,0 mm	RBA1 15696
ø 4,8 mm	RTV7 28761	ø 4,5 mm	RBA1 15698
ø 5,2 mm	RTV7 28763		
ø 6,0 mm	RTV7 28764		
ø 7,0 mm	RTV7 28765		
ø 8,0 mm	RTV7 28766		

LVZE 22-2W	
Düsenø	Wende-Einsatz ohne
Nozzleø	Part circle insert without
ø 4,2x4,0	RBK5 17 247
ø 4,8x4,0	RBK5 17 246
ø 5,2x4,0	RBK5 17 245
ø 6,0x4,0	RBK5 17 244
ø 7,0x4,5	RBK5 17 243
ø 8,0x4,5	RBK5 17 242

A	RBR2 16711
B	RBB2 15645

LVZE 22-2WD	
Düsenø	Wende-Einsatz ohne
Nozzleø	Part circle insert without
ø 4,2x4,0x4,2	RBK5 17 241
ø 4,8x4,0x4,2	RBK5 17 240
ø 5,2x4,0x4,2	RBK5 17 239
ø 6,0x4,0x4,2	RBK5 17 238
ø 7,0x4,5x4,2	RBK5 17 237
ø 8,0x4,5x4,2	RBK5 17 236

Montage-Werkzeug
Assembling tool

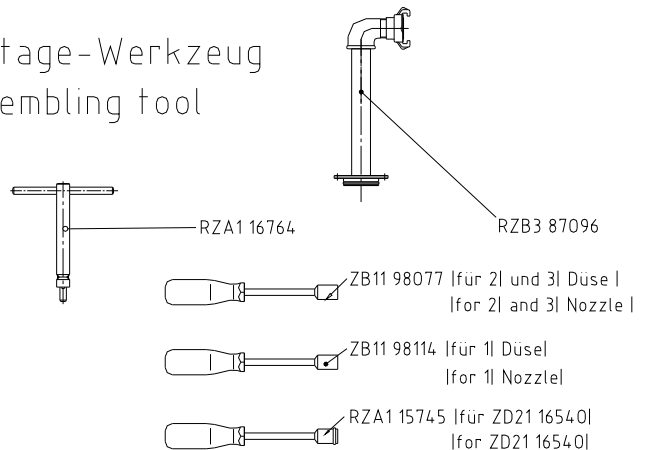

Stand: 04.08.2010
ERV9 00328

LVZE 22-1 H / -2 WH / -2 WDH

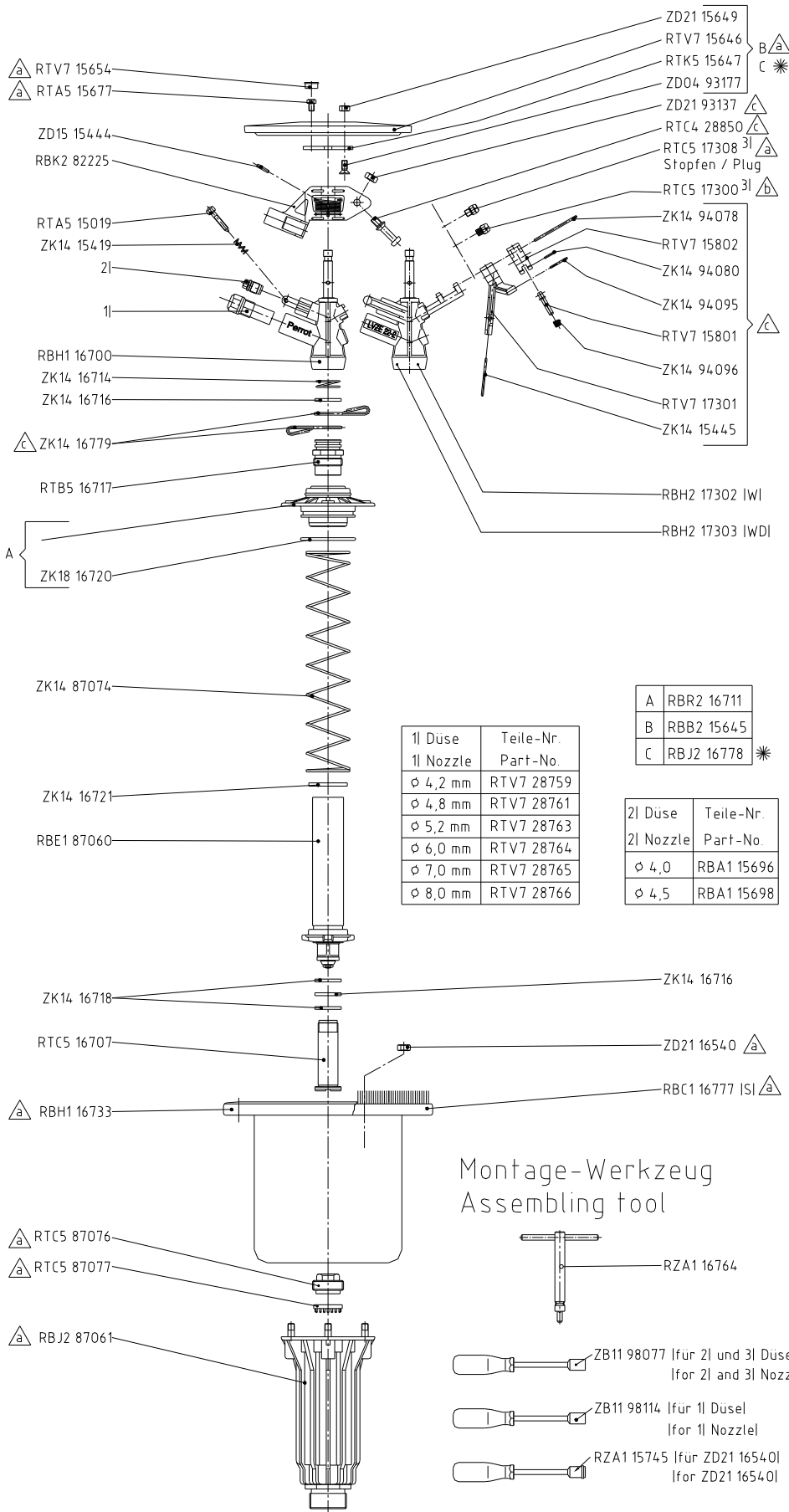

LVZE 22-1H	
Düsenø	Kreis-Einsatz ohne
Nozzleø	Full circle insert without
ø4,2x4,0x3,0	RBK5 87 006
ø4,8x4,0x3,0	RBK5 87 007
ø5,2x4,0x3,0	RBK5 87 008
ø6,0x4,0x3,0	RBK5 87 009
ø7,0x4,5x3,0	RBK5 87 010
ø8,0x4,5x3,0	RBK5 87 011

LVZE 22-2WH	
Düsenø	Wende-Einsatz ohne
Nozzleø	Part circle insert without
ø 4,2x4,0	RBK5 17 399
ø 4,8x4,0	RBK5 17 398
ø 5,2x4,0	RBK5 17 397
ø 6,0x4,0	RBK5 17 396
ø 7,0x4,5	RBK5 17 395
ø 8,0x4,5	RBK5 17 394

LVZE 22-2WDH	
Düsenø	Wende-Einsatz ohne
Nozzleø	Part circle insert without
ø4,2x4,0x4,2	RBK5 17 235
ø4,8x4,0x4,2	RBK5 17 234
ø5,2x4,0x4,2	RBK5 17 233
ø6,0x4,0x4,2	RBK5 17 232
ø7,0x4,5x4,2	RBK5 17 231
ø8,0x4,5x4,2	RBK5 17 230

1l Düse	Teile-Nr.
1l Nozzle	Part-No.
ø 4,2 mm	RTV7 28759
ø 4,8 mm	RTV7 28761
ø 5,2 mm	RTV7 28763
ø 6,0 mm	RTV7 28764
ø 7,0 mm	RTV7 28765
ø 8,0 mm	RTV7 28766

A	RBR2 16711
B	RBB2 15645
C	RBJ2 16778 *

2l Düse	Teile-Nr.
2l Nozzle	Part-No.
ø 4,0	RBA1 15696
ø 4,5	RBA1 15698

Montage-Werkzeug
Assembling tool

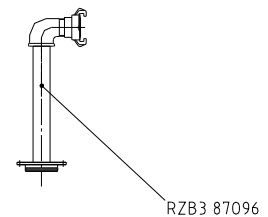
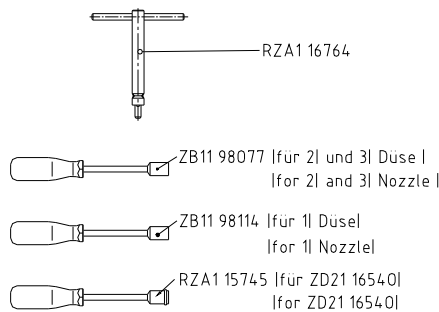

*Gehäusedeckel mit Rasen nur montiert lieferbar
Cover with artificial-grass only as assy available

Stand: 04.08.2010
ERV9 00329

LVZE 22-1 VAC Gehäuse, Unterbau / Cover

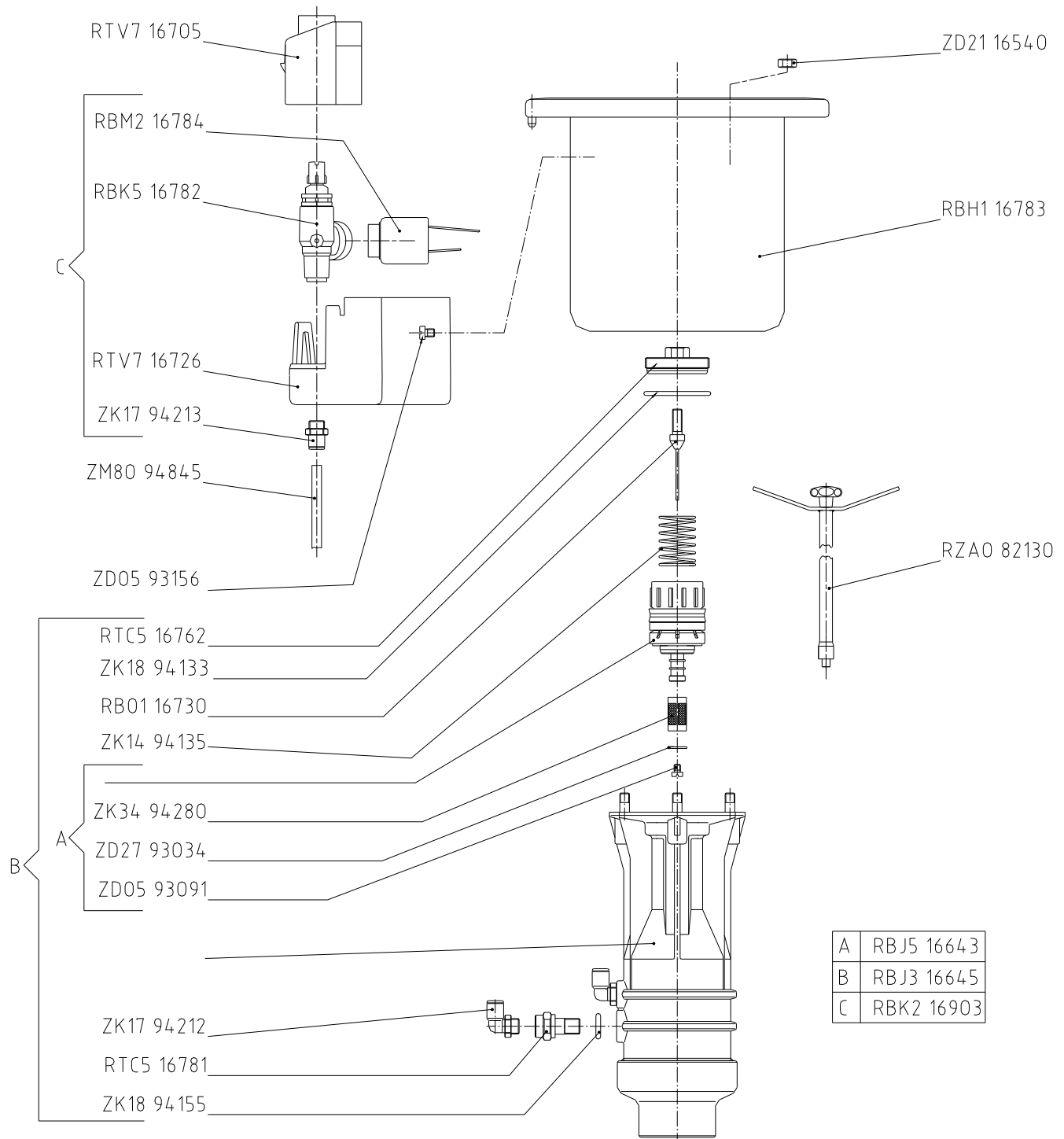

A	RBJ5 16643
B	RBJ3 16645
C	RBK2 16903

Stand: 15.09.2008
ERV9 00317

LVZR 22-3 Regnereinsatz / Sprinkler-insert

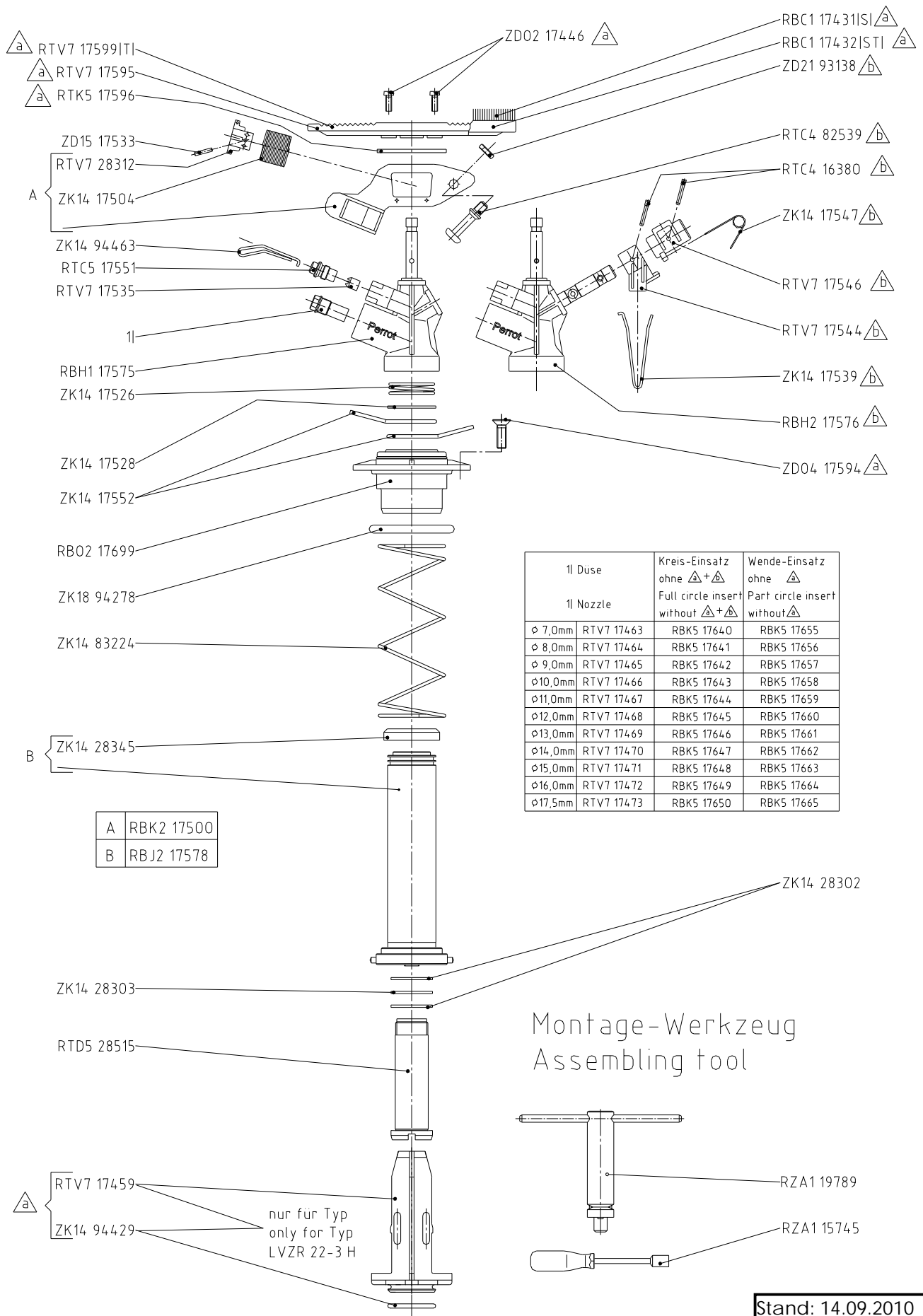

1l Duse 1l Nozzle		Kreis-Einsatz ohne \triangle + \triangle Full circle insert without \triangle + \triangle	Wende-Einsatz ohne \triangle Part circle insert without \triangle
ϕ 7,0mm	RTV7 17463	RBK5 17640	RBK5 17655
ϕ 8,0mm	RTV7 17464	RBK5 17641	RBK5 17656
ϕ 9,0mm	RTV7 17465	RBK5 17642	RBK5 17657
ϕ 10,0mm	RTV7 17466	RBK5 17643	RBK5 17658
ϕ 11,0mm	RTV7 17467	RBK5 17644	RBK5 17659
ϕ 12,0mm	RTV7 17468	RBK5 17645	RBK5 17660
ϕ 13,0mm	RTV7 17469	RBK5 17646	RBK5 17661
ϕ 14,0mm	RTV7 17470	RBK5 17647	RBK5 17662
ϕ 15,0mm	RTV7 17471	RBK5 17648	RBK5 17663
ϕ 16,0mm	RTV7 17472	RBK5 17649	RBK5 17664
ϕ 17,5mm	RTV7 17473	RBK5 17650	RBK5 17665

Stand: 14.09.2010
ERV9 00298

LVZR 22-3 Gehäuse, Unterbau / Cover

RBH1 17571
RBH1 17574 |TI|

RBC1 17428 |SI|
RBC1 17429 |STI|

RTV7 17460
nur für Typ
only for Typ
LVZR 22-3 H

RBH1 17555

Montage-Werkzeug
Assembling tool

RZG2 17623

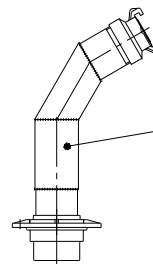
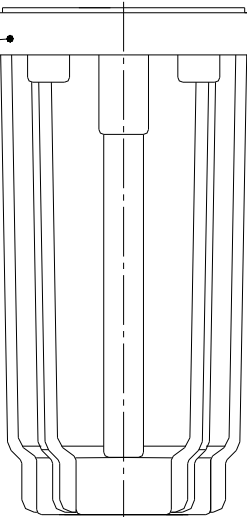
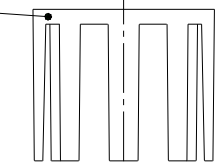
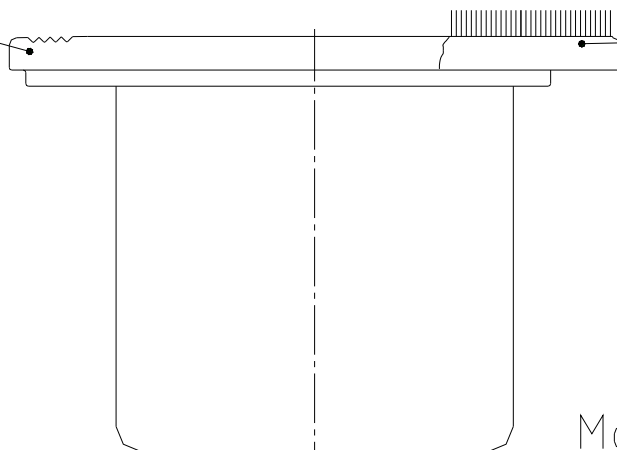

Stand: 24.09.2008
ERV9 00300

LVZR 22-3V Gehäuse, Unterbau / Cover

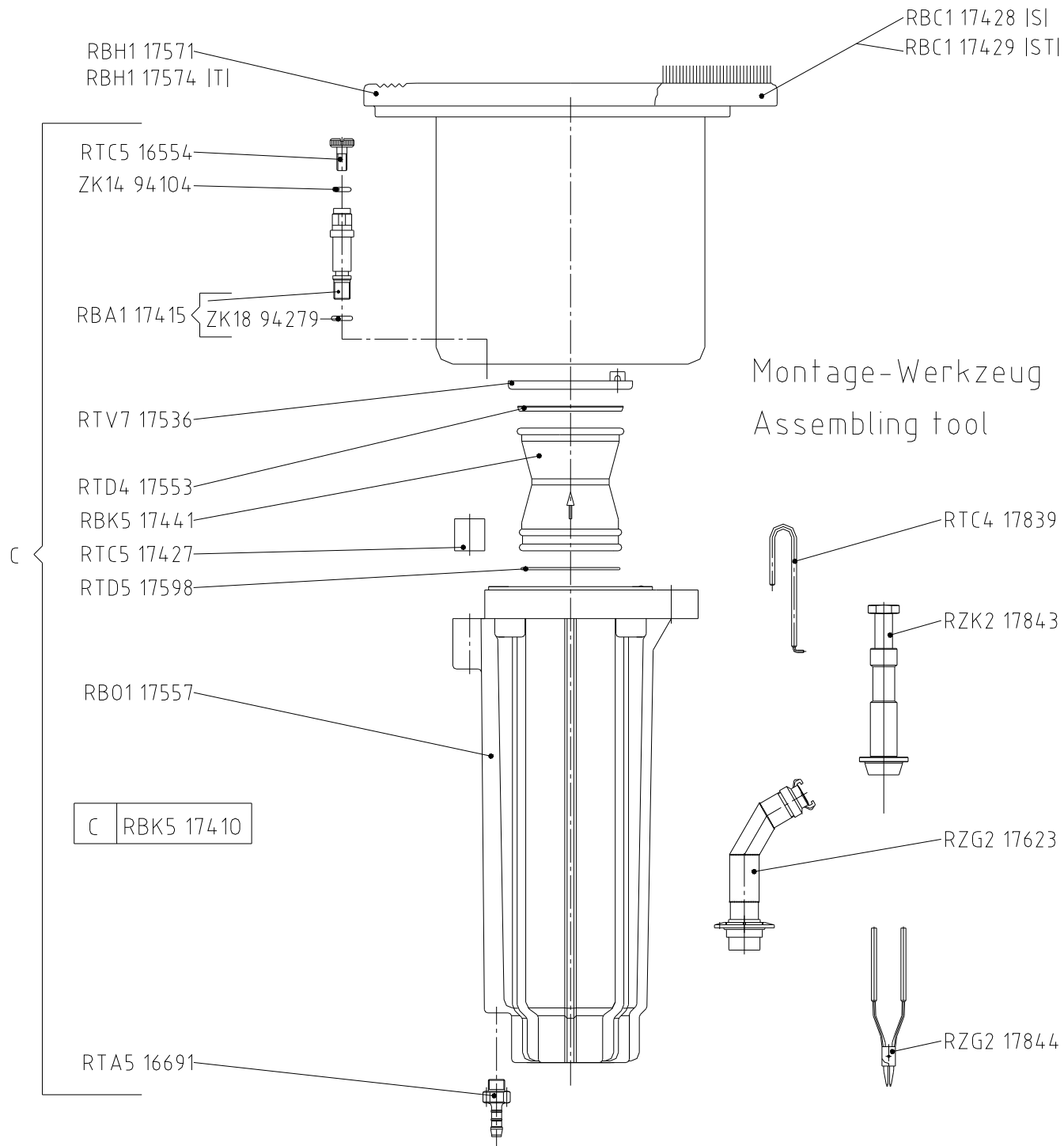

Stand: 24.09.2008
ERV9 00301

LVZR - 22-3VAC Gehäuse, Unterbau / Cover

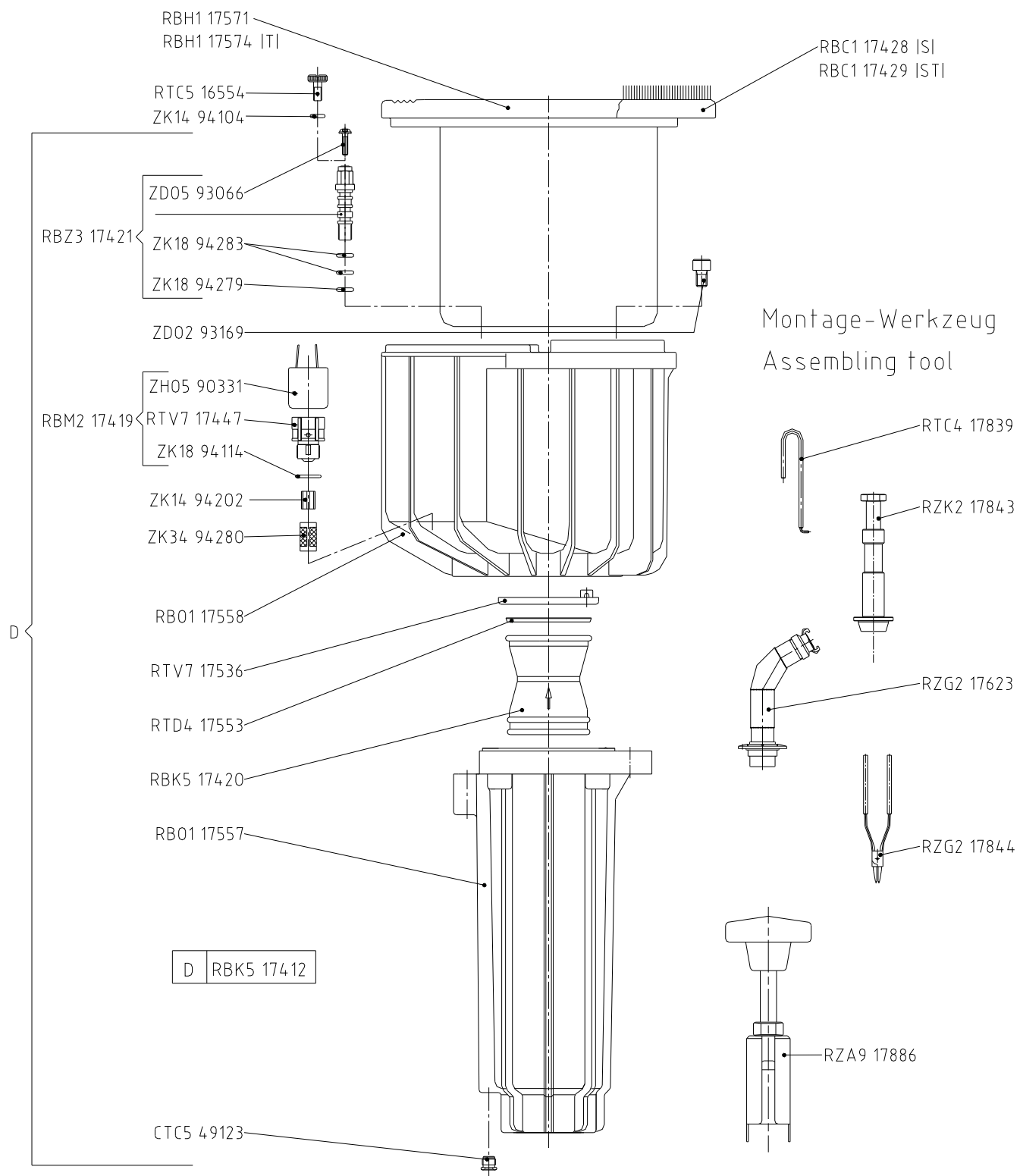

Stand: 07.10.2008
ERV9 00302

LVZR 22-3VDE Gehäuse, Unterbau / Cover

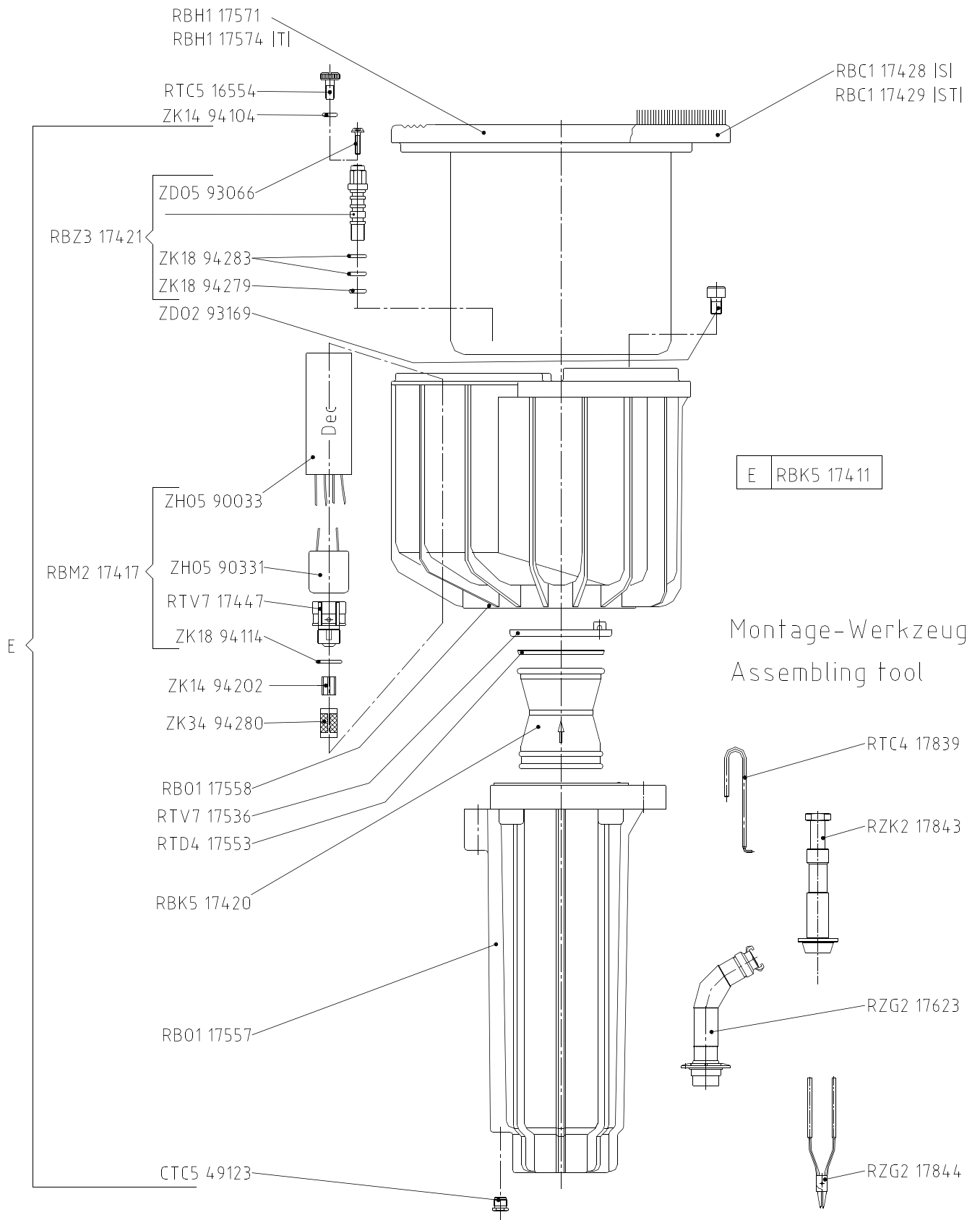

Stand: 06.10.2008
ERV9 00303

LVZR 22-3VFDE Gehäuse, Unterbau / Cover

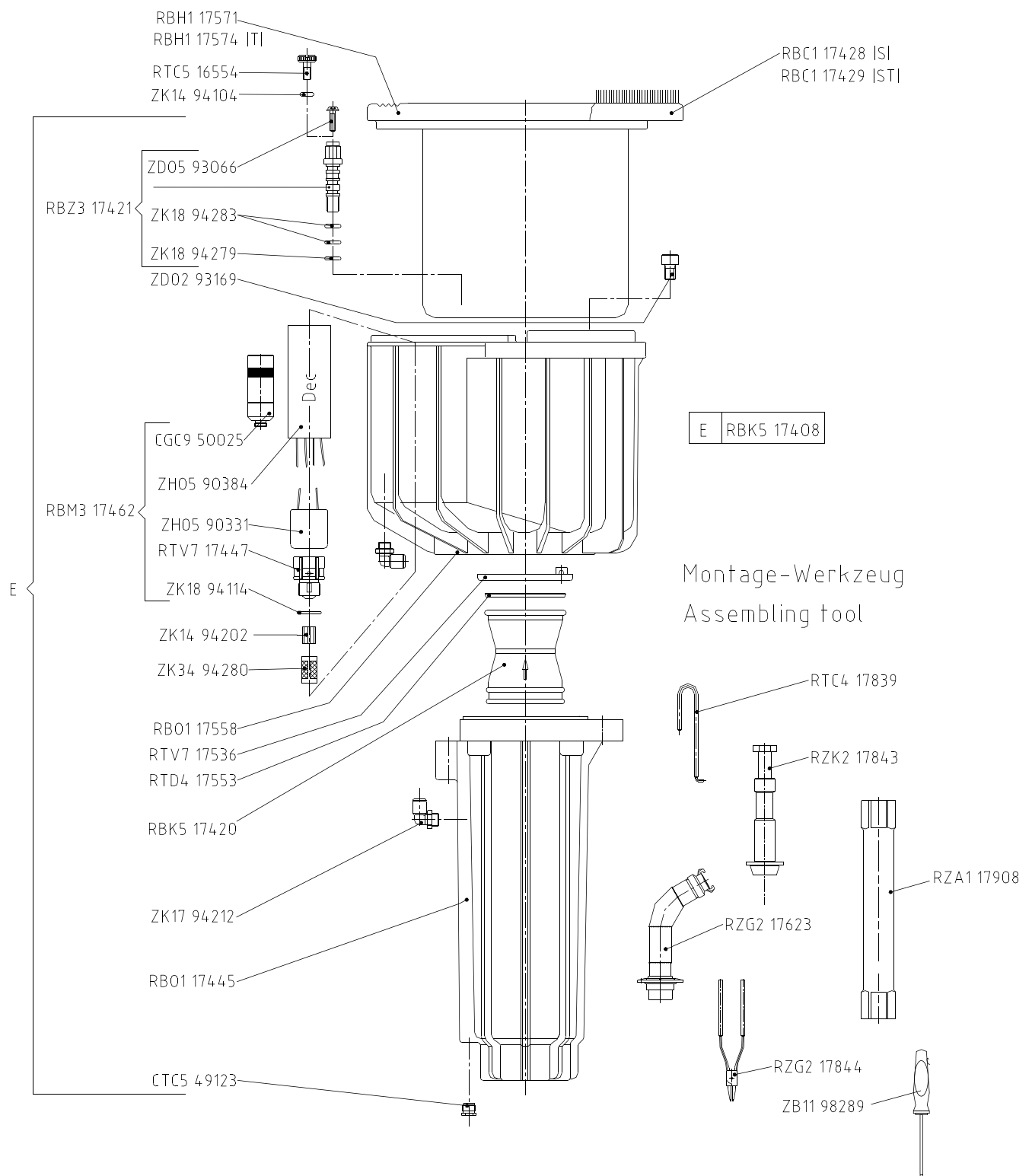

Stand: 13.05.2009
 ERV9 00319

RVR 22-3 Regnereinsatz / Sprinkler-insert

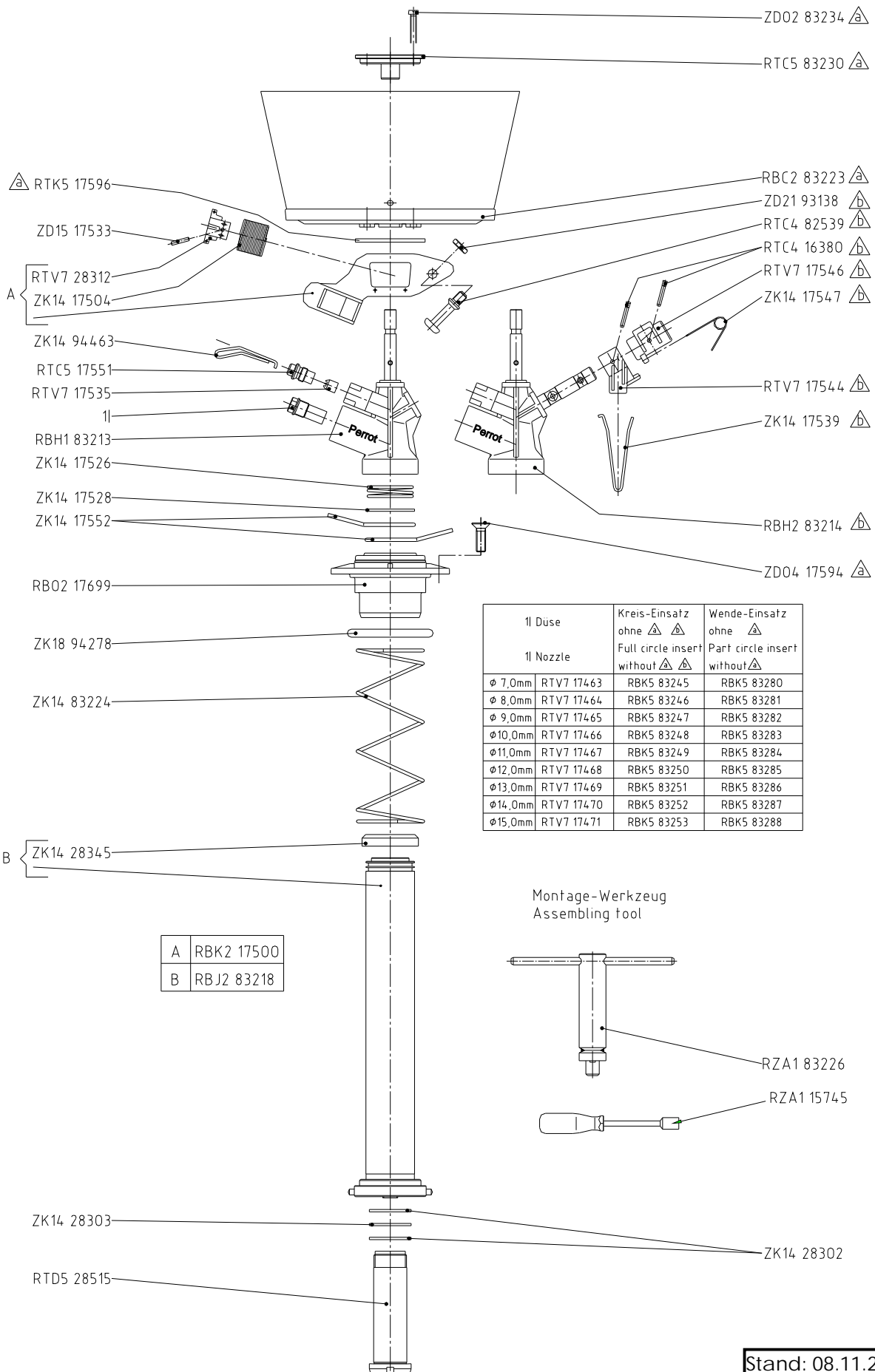

Stand: 08.11.2010
ERV9 00299

RVR 22-3 Gehäuse, Unterbau / Cover

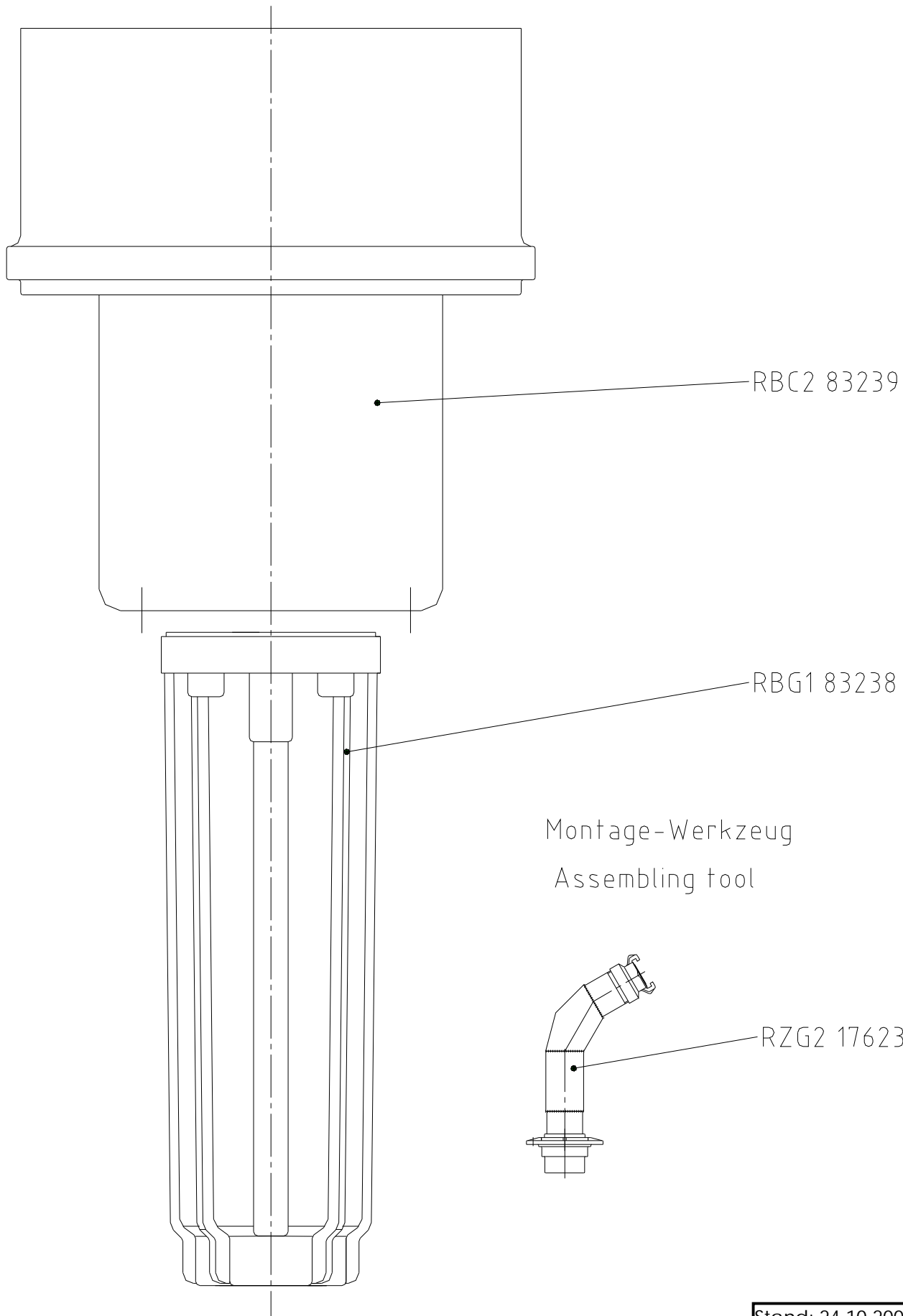

Stand: 24.10.2000
ERV9 00304

RVR 22-3V Gehäuse, Unterbau / Cover

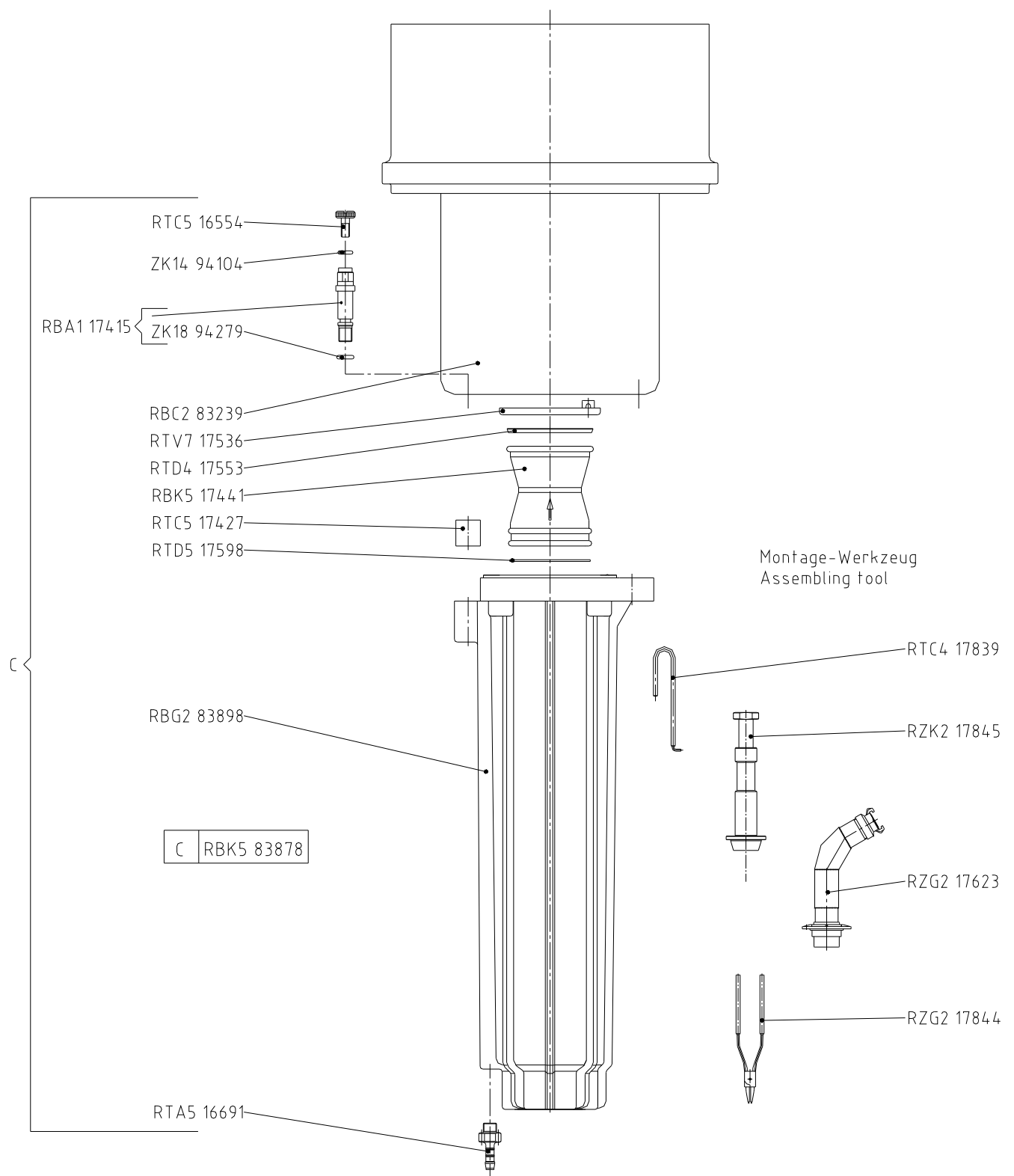

Stand: 24.10.2000
ERV9 00305

RVR 22-3VAC Gehäuse, Unterbau / Cover

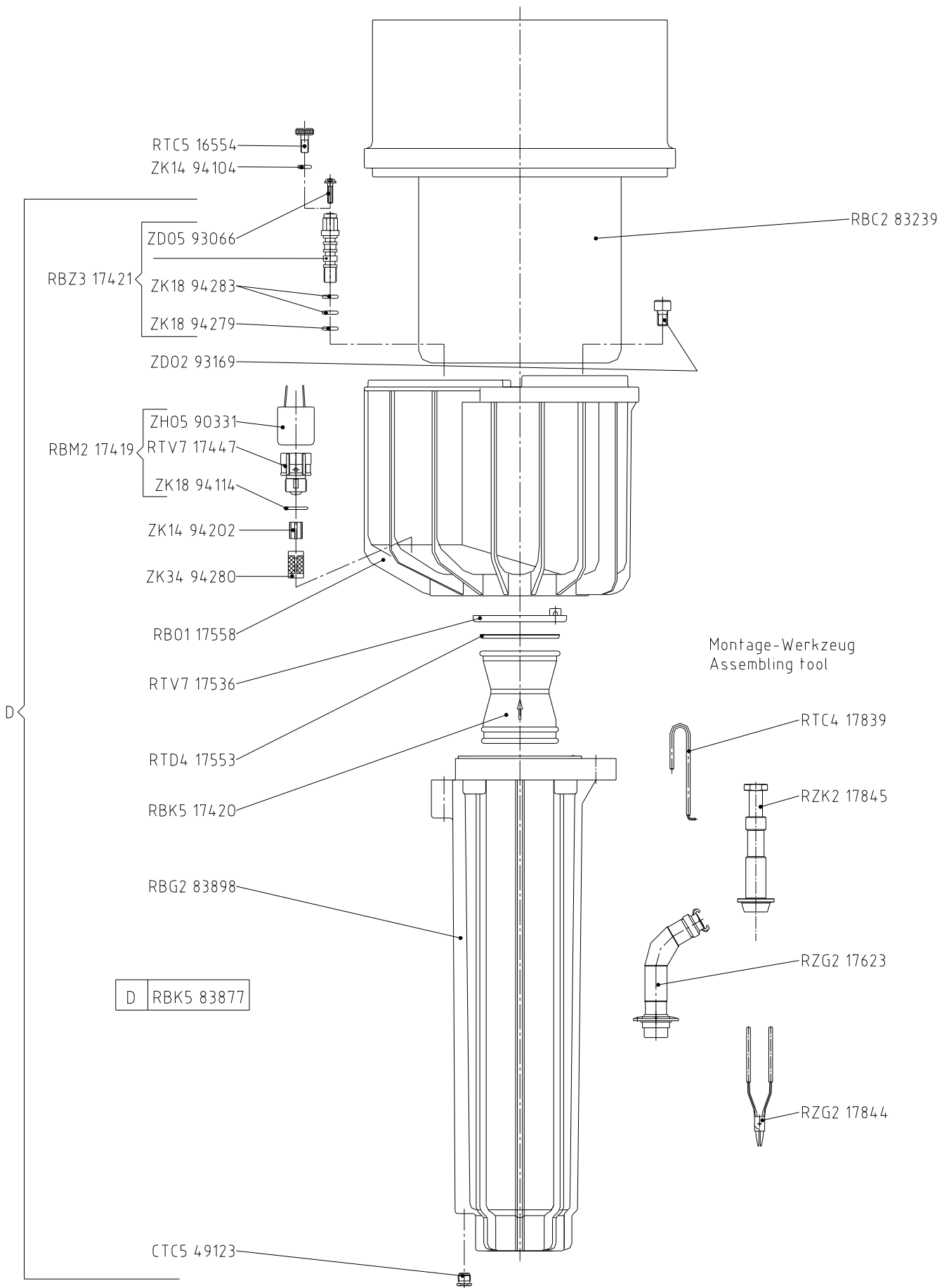

Stand: 07.10.2008
ERV9 00306

VP2M

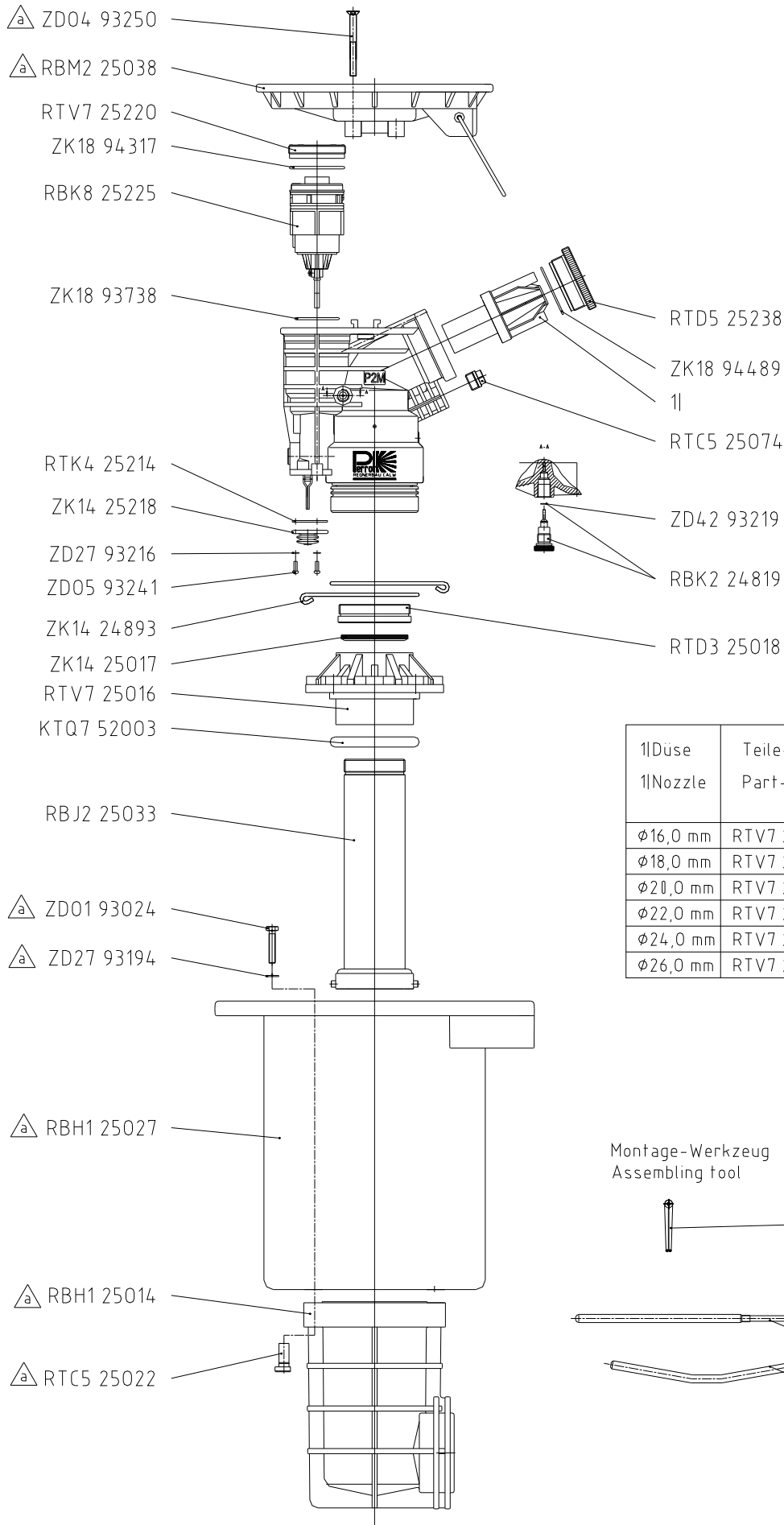

1IDüse 1I Nozzle	Teile-Nr. Part-No.	Einsatz ohne △ Insert without △
φ16,0 mm	RTV7 25230	RBK5 25170
φ18,0 mm	RTV7 25231	RBK5 25171
φ20,0 mm	RTV7 25232	RBK5 25172
φ22,0 mm	RTV7 25233	RBK5 25173
φ24,0 mm	RTV7 25234	RBK5 25174
φ26,0 mm	RTV7 25235	RBK5 25175

Montage-Werkzeug
Assembling tool

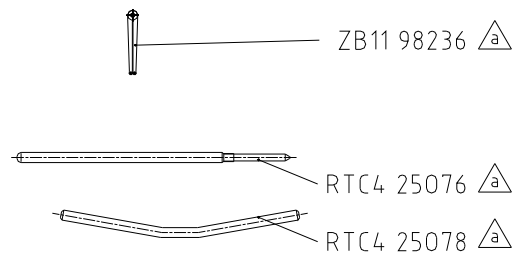

Stand: 11.03.2010
ERV9 00340

HYDRA-S & -XS H / WH / -S WDH Einsatz / Insert

RTV7 14365 —————
Wende / Part Circle

RTV7 14393 —————
Kreis / Full Circle

RTC5 14441 —————
Stopfen / Plug

RTC5 14440 —————
Düse / Nozzle

Düse / Nozzle 
ZK18 93780

RBK6 14401 —————
Wende / Part Circle

RBK6 14400 —————
Kreis / Full Circle

ZK18 93689 —————

Montage-Werkzeug
Assembling Tool

ZB11 98276
für Düsenwechsel/
for changing nozzle

RTV7 14449 —————
nur für Hydra-XS H
4mm Düse
only for Hydra-XS H
4mm Nozzle

RTV7 14317 —————

RBK2 14403 —————

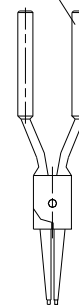

Hydra-S H Kreis-Einsatz/ Full Circle Insert	Hydra-S WH Wende-Einsatz / Part Circle Insert	Hydra-S WDH Wende-Einsatz / Part Circle Insert
RBA3 14585 9,0mm	RBA3 14595 9,0mm	RBA3 14625 9,0mm
RBA3 14584 8,0mm	RBA3 14594 8,0mm	RBA3 14624 8,0mm
RBA3 14583 7,0mm	RBA3 14593 7,0mm	RBA3 14623 7,0mm
RBA3 14582 6,0mm	RBA3 14592 6,0mm	RBA3 14622 6,0mm
RBA3 14581 5,0mm	RBA3 14591 5,0mm	RBA3 14621 5,0mm
RBA3 14580 4,0mm	RBA3 14590 4,0mm	RBA3 14620 4,0mm

Hydra-XS H Kreis-Einsatz/ Full Circle Insert	Hydra-XS WH Wende-Einsatz / Part Circle Insert
RBA3 14652 6,0mm	RBA3 14657 6,0mm
RBA3 14651 5,0mm	RBA3 14656 5,0mm
RBA3 14650 4,0mm	RBA3 14655 4,0mm

	Düse / Nozzle	
	Hydra- S H/WH/WDH	Hydra- XS H/WH
ø9,0 mm	RBE2 14666	
ø8,0 mm	RBE2 14665	
ø7,0 mm	RBE2 14664	
ø6,0 mm	RBE2 14663	RTV7 14452
ø5,0 mm	RBE2 14662	RTV7 14451
ø4,0 mm	RBE2 14661	RTV7 14450

Stand: 19.04.2010
ERV9 900338

HYDRA-S & -XS H/WH Gehäuse / Unterbau / Cover

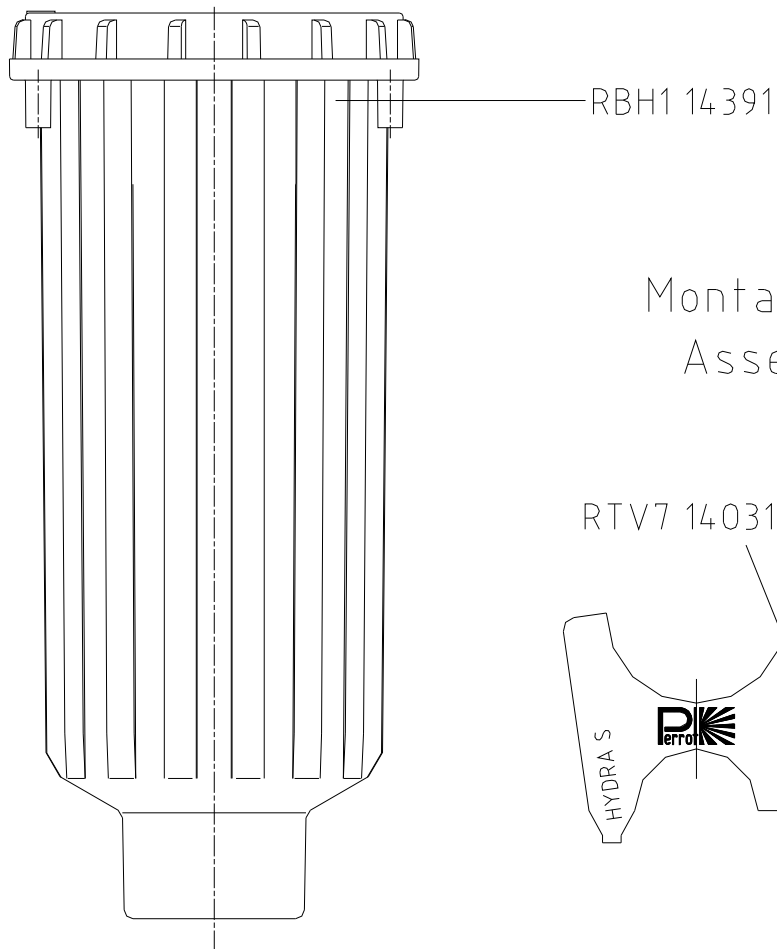
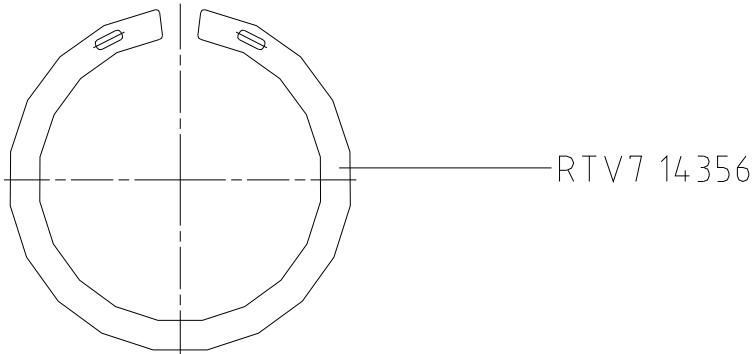
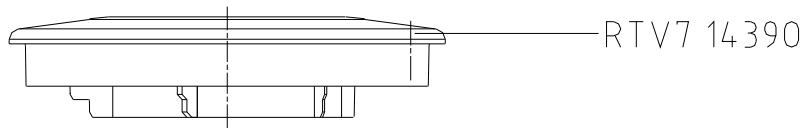
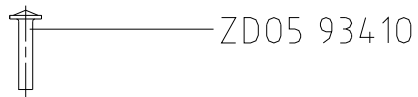

Montage-Werkzeug
Assembling Tool

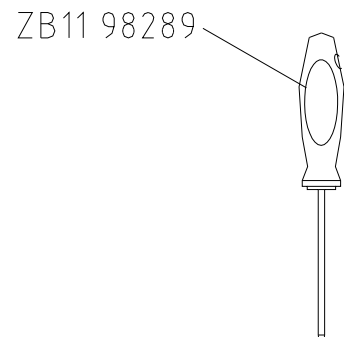
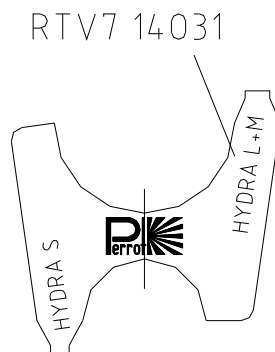

Stand: 29.09.2010
ERV9 900339

HYDRA-S VAC / WVAC / WDVAC Einsatz / Insert

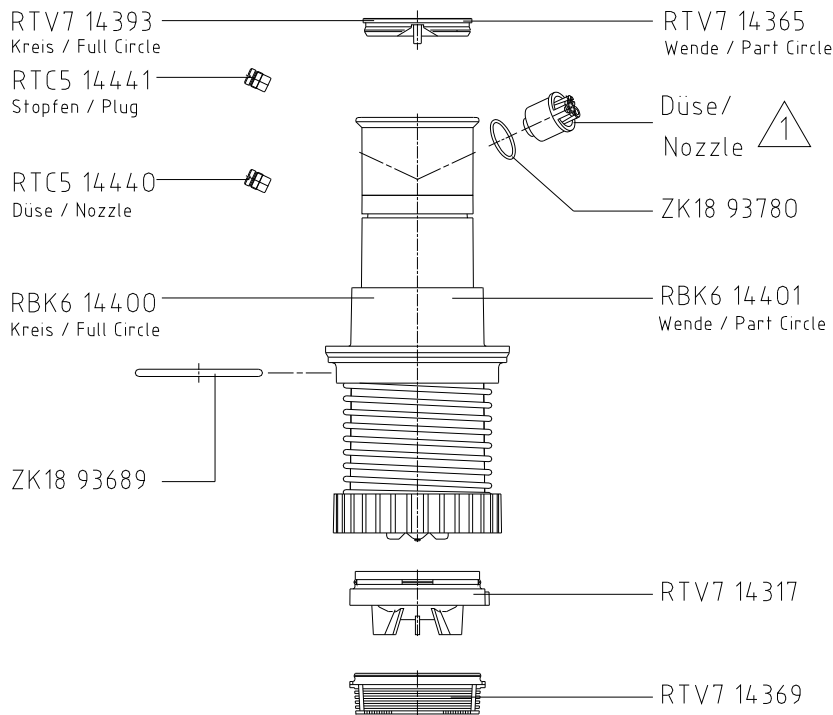

Montage-Werkzeug
 Assembling Tool

ZB11 98276
 für Düsenwechsel/
 for change Nozzle

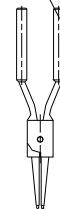

Hydra-S VAC Kreis-Einsatz/ Full Circle Insert	Hydra-S WVAC Wende-Einsatz / Part Circle Insert	Hydra-S WDVAC Wende-Einsatz / Part Circle Insert
RBA3 14605 9,0mm	RBA3 14615 9,0mm	RBA3 14635 9,0mm
RBA3 14604 8,0mm	RBA3 14614 8,0mm	RBA3 14634 8,0mm
RBA3 14603 7,0mm	RBA3 14613 7,0mm	RBA3 14633 7,0mm
RBA3 14602 6,0mm	RBA3 14612 6,0mm	RBA3 14632 6,0mm
RBA3 14601 5,0mm	RBA3 14611 5,0mm	RBA3 14631 5,0mm
RBA3 14600 4,0mm	RBA3 14610 4,0mm	RBA3 14630 4,0mm

 Düse / Nozzle	
∅9,0 mm	RBE2 14666
∅8,0 mm	RBE2 14665
∅7,0 mm	RBE2 14664
∅6,0 mm	RBE2 14663
∅5,0 mm	RBE2 14662
∅4,0 mm	RBE2 14661

Stand: 19.04.2010
 ERV9 900336

HYDRA-S VAC / WVAC / WDVAC Gehäuse / Unterbau / Cover

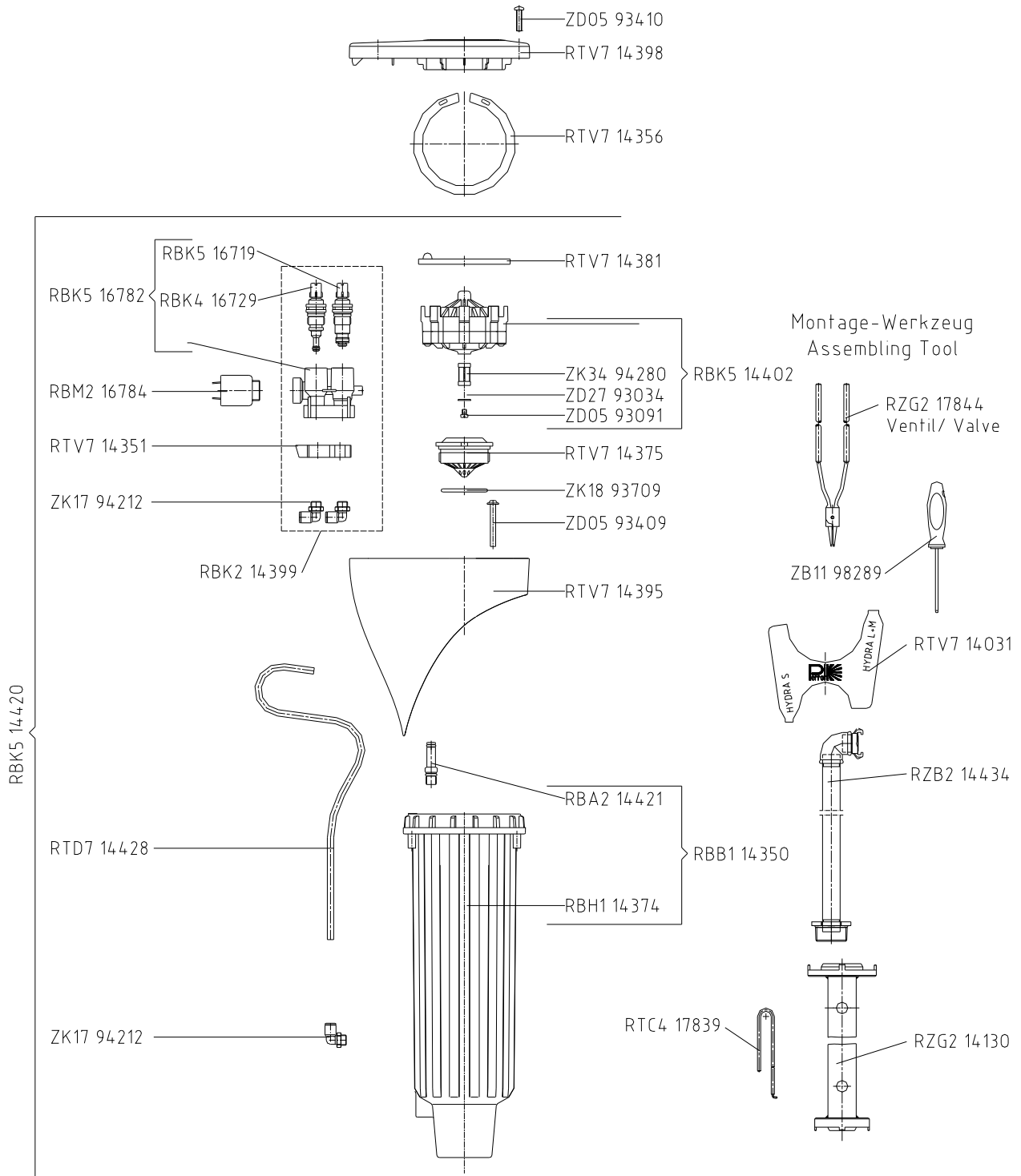

Stand: 15.12.2010
ERV9 900337

HYDRA-M SH / WSH Einsatz / Insert

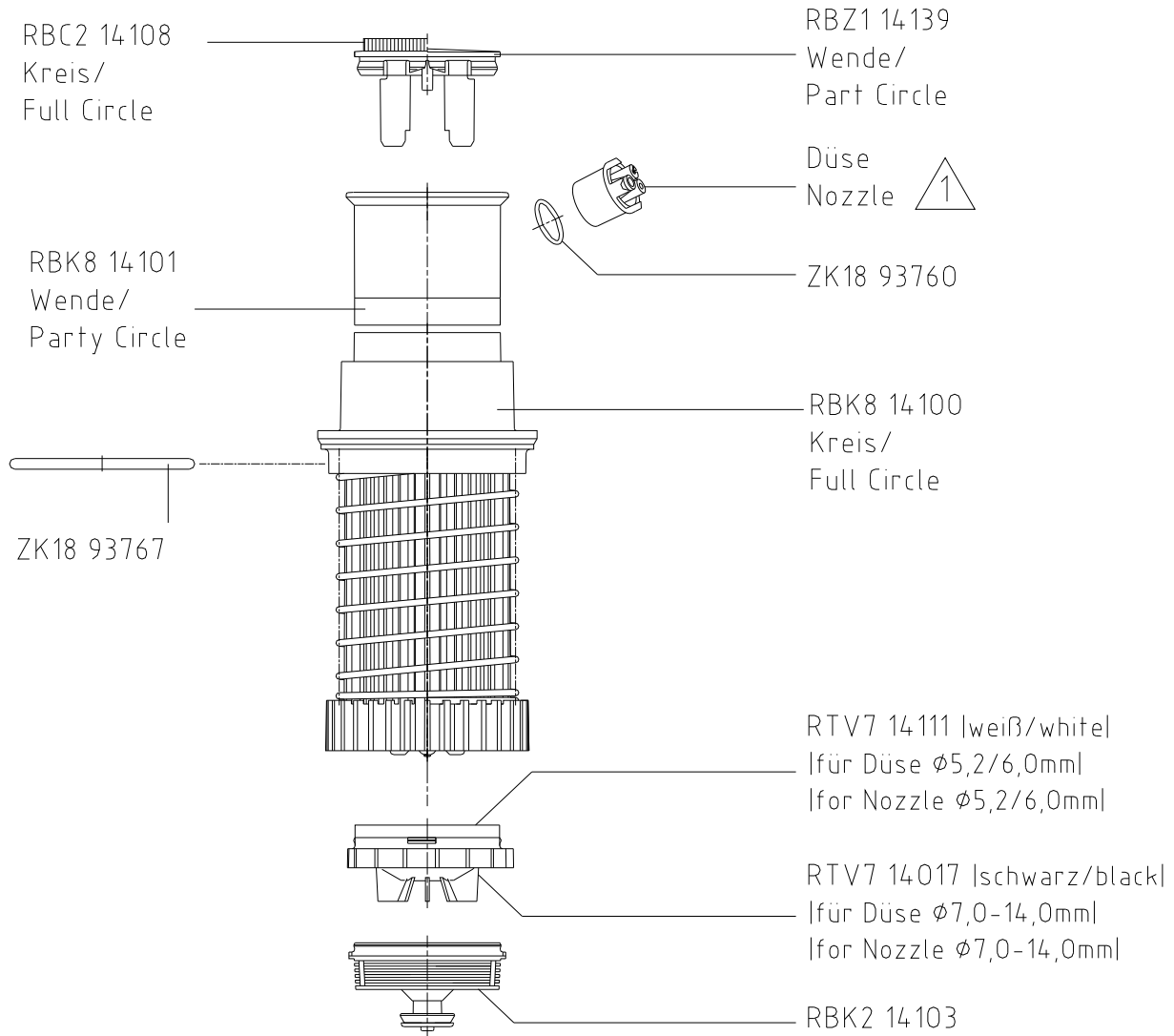

Hydra-M SH Kreis-Einsatz/ Full Circle Insert	Hydra-M WSH Wende-Einsatz / Part Circle Insert
RBA3 14179 14,0mm	RBA3 14189 14,0mm
RBA3 14178 13,0mm	RBA3 14188 13,0mm
RBA3 14177 12,0mm	RBA3 14187 12,0mm
RBA3 14176 11,0mm	RBA3 14186 11,0mm
RBA3 14175 10,0mm	RBA3 14185 10,0mm
RBA3 14174 9,0mm	RBA3 14184 9,0mm
RBA3 14173 8,0mm	RBA3 14183 8,0mm
RBA3 14172 7,0mm	RBA3 14182 7,0mm
RBA3 14171 6,0mm	RBA3 14181 6,0mm
RBA3 14170 5,2mm	RBA3 14180 5,2mm

Düse / Nozzle	
φ14,0 mm	RBE2 14679
φ13,0 mm	RBE2 14678
φ12,0 mm	RBE2 14677
φ11,0 mm	RBE2 14676
φ10,0 mm	RBE2 14675
φ9,0 mm	RBE2 14674
φ8,0 mm	RBE2 14673
φ7,0 mm	RBE2 14672

Stand: 19.04.2010
ERV9 900335

HYDRA-M SH / WSH Gehäuse / Unterbau / Cover

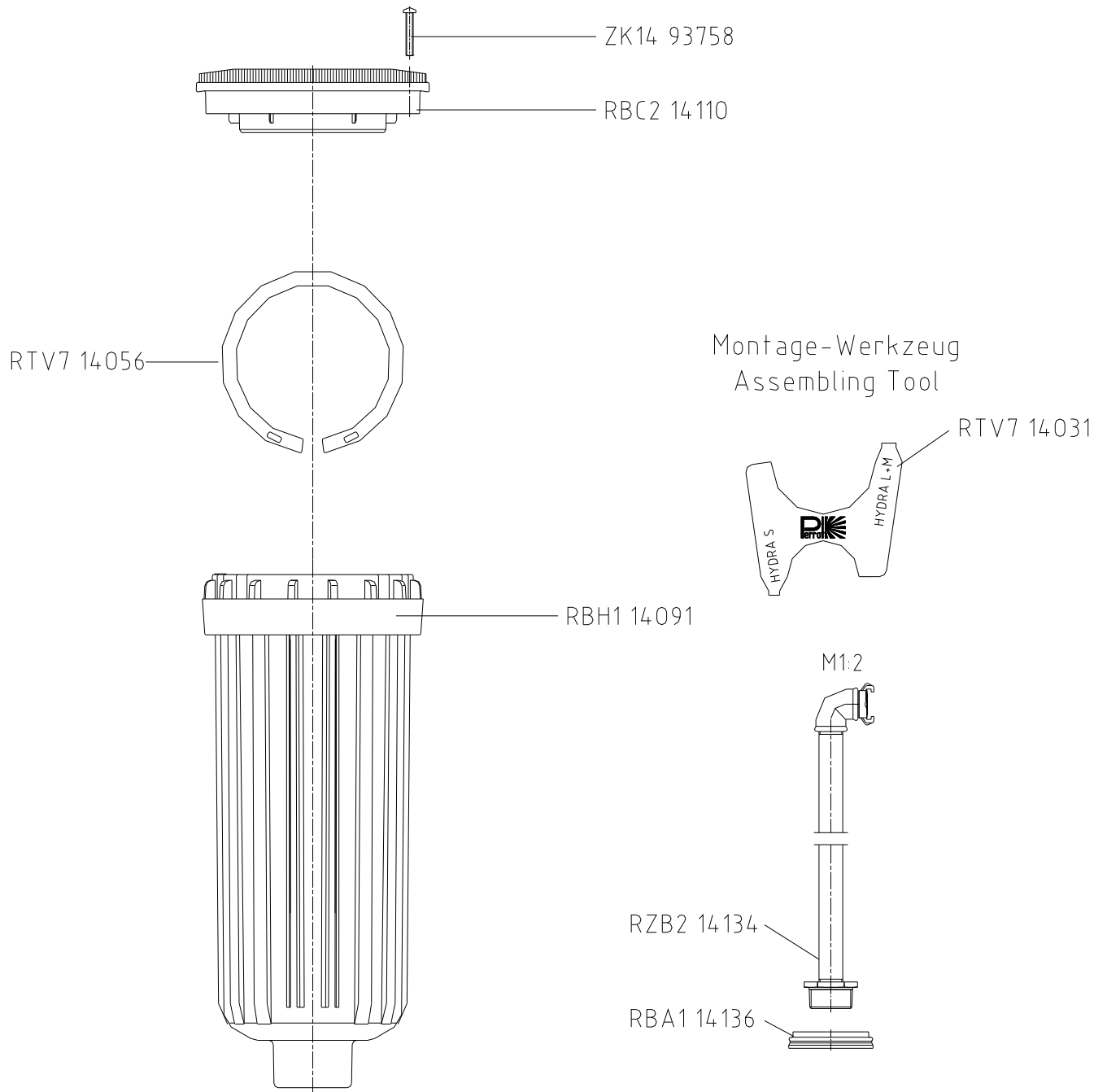

Stand: 12.05.2009
ERV9 900333

HYDRA-L SVAC / WSVAC Einsatz / Insert

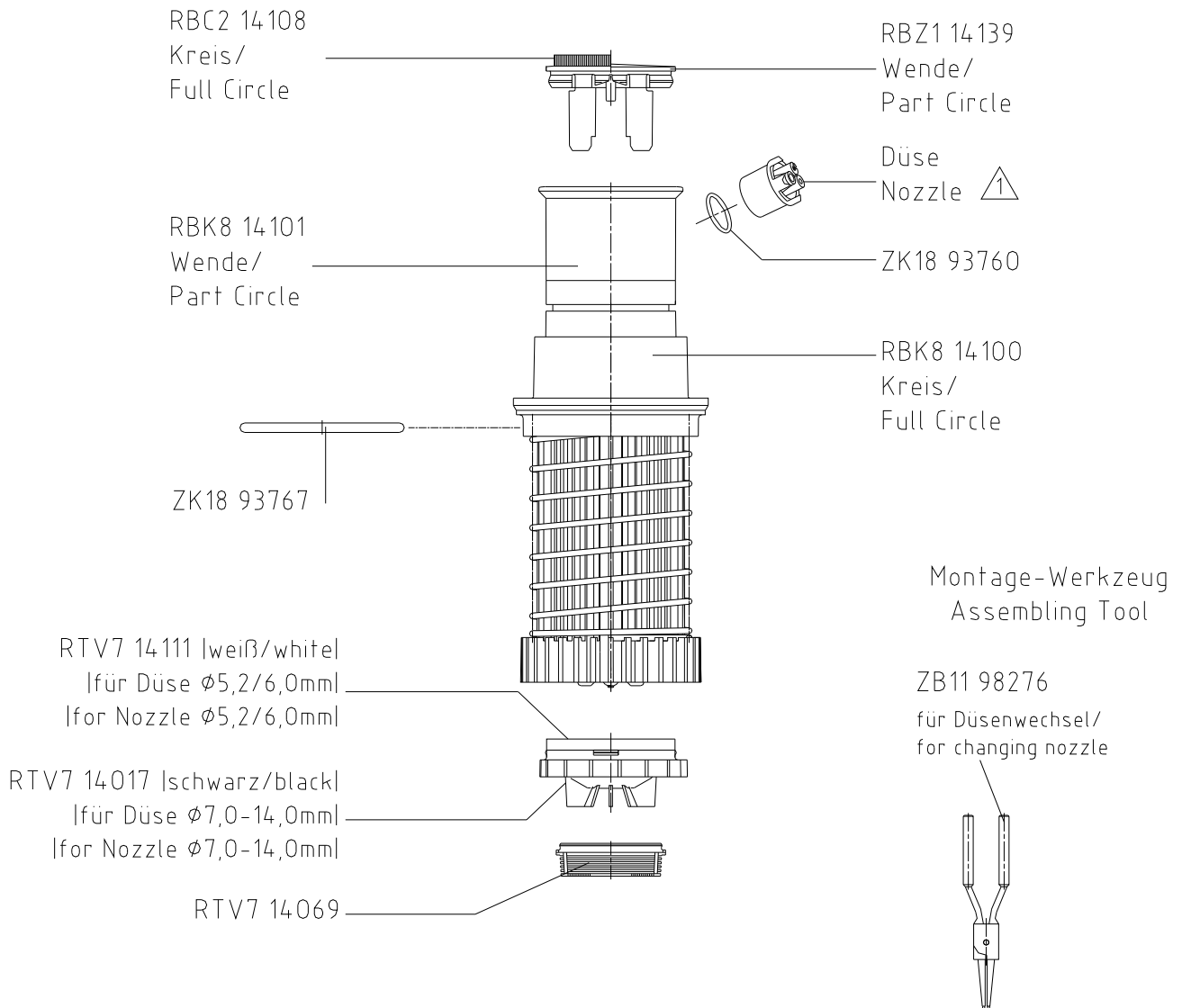

Hydra-L VAC Kreis-Einsatz/ Full Circle Insert	Hydra-L WVAC Wende-Einsatz / Part Circle Insert
RBA3 14219 14,0mm	RBA3 14229 14,0mm
RBA3 14218 13,0mm	RBA3 14228 13,0mm
RBA3 14217 12,0mm	RBA3 14227 12,0mm
RBA3 14216 11,0mm	RBA3 14226 11,0mm
RBA3 14215 10,0mm	RBA3 14225 10,0mm
RBA3 14214 9,0mm	RBA3 14224 9,0mm
RBA3 14213 8,0mm	RBA3 14223 8,0mm
RBA3 14212 7,0mm	RBA3 14222 7,0mm
RBA3 14211 6,0mm	RBA3 14221 6,0mm
RBA3 14210 5,2mm	RBA3 14220 5,2mm

$\triangle 1$ Düse / Nozzle	
$\phi 14,0$ mm	RBE2 14679
$\phi 13,0$ mm	RBE2 14678
$\phi 12,0$ mm	RBE2 14677
$\phi 11,0$ mm	RBE2 14676
$\phi 10,0$ mm	RBE2 14675
$\phi 9,0$ mm	RBE2 14674
$\phi 8,0$ mm	RBE2 14673
$\phi 7,0$ mm	RBE2 14672

Stand: 19.04.2010
ERV9 900334

